

# CENTRIFUGAL IN LINE FANS FOR CIRCULAR DUCTS

Series  
**FV-D**



FV-D 200

				DELIVERY MC/H																
	w	db(A)	m3/h	50	100	150	200	250	300	350	400	450	500	550	600	650	700	750	800	
<b>FV-D 100</b>	58	47	260	29	25	16	9	2,5												
<b>FV-D 125</b>	58	47	360	30	27,5	22	17	11,5	6	2										
<b>FV-D 160A</b>	58	50	410	31	29	25	20	15	10	6	2									
<b>FV-D 160B</b>	75	51	560			29	28	26	23	20	17	14	11	8	5	3	1			

				DELIVERY MC/H																
	w	db(A)	m3/h	200	300	400	500	600	700	800	900	1000	1100	1200	1300	1400	1500	1600	1700	
<b>FV-D 200</b>	75	52	690	28	25	19	13	8	2											
<b>FV-D 250</b>	135	54	990	45	41	36	30	25	20	15	10	5	1							
<b>FV-D 315A</b>	155	55	1260		45	41	38	35	32	28	24	20	16	11	6	1				
<b>FV-D 315B</b>	225	56	1750		55	52	49	46	43	40	37	34	30	26	21	16	11	7	2	

Sito Web



Catalogo Generale



**Feit Pompe S.r.l.**

Via Venezia, 34/g - 10088 - Volpiano (TO) - ITALIA  
Tel: +39 (0)11 9884327 - info@feit.srl - feit.srl

**FEIT**  
1946  
Evolving with you...

# CENTRIFUGAL IN LINE FANS FOR CIRCULAR DUCTS

Series  
**FV-D**

## CHARACTERISTICS

- Casing in weather proof steel sheet.
- Steel sheet motor supports with airflow straighteners.
- External rotor motor IP44 protection ISO B, speed adjustable by electronic speed regulator. High efficiency backward blade impeller.
- Terminal box in techno-polymer.

Its compact steel structure, external rotor motor and centrifugal backward bladed impeller ensure:

- easy installation
- flexible working by adjusting the rpm
- high efficiency
- sturdiness and reliability

## APPLICATIONS

- FV D line is ideal to intake or exhaust air through circular ducting in: public locals, offices, shops, bars,

pools, laboratories, kitchens, toilets, workshops, restaurants etc.

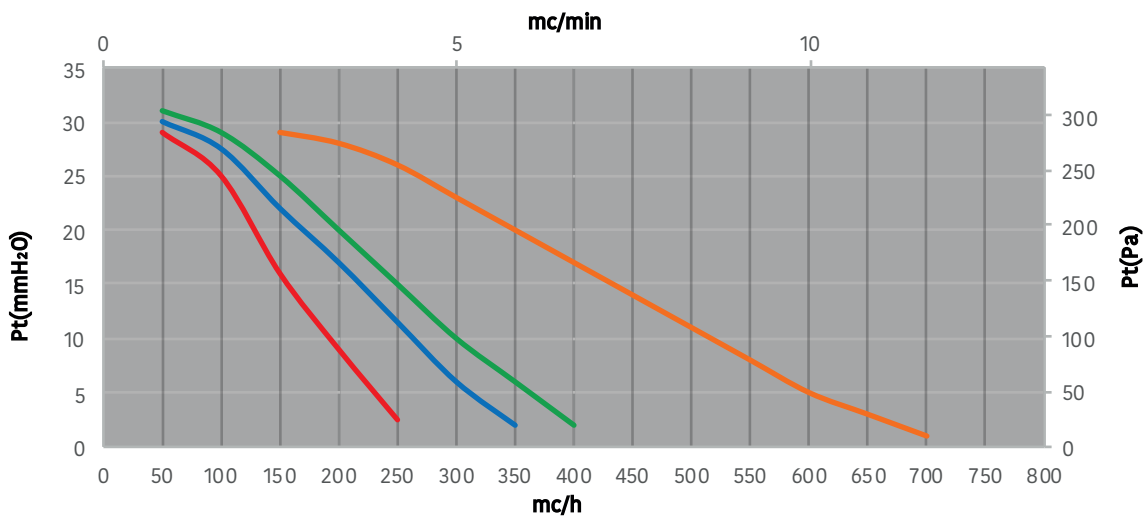

	VOLT	RPM
<b>FV-D 100</b>	230m	2900
<b>FV-D 160B</b>	230m	2900

	VOLT	RPM
<b>FV-D 125</b>	230m	2900

	VOLT	RPM
<b>FV-D 160A</b>	230m	2900

# CENTRIFUGAL IN LINE FANS FOR CIRCULAR DUCTS

Series  
**FV-D**

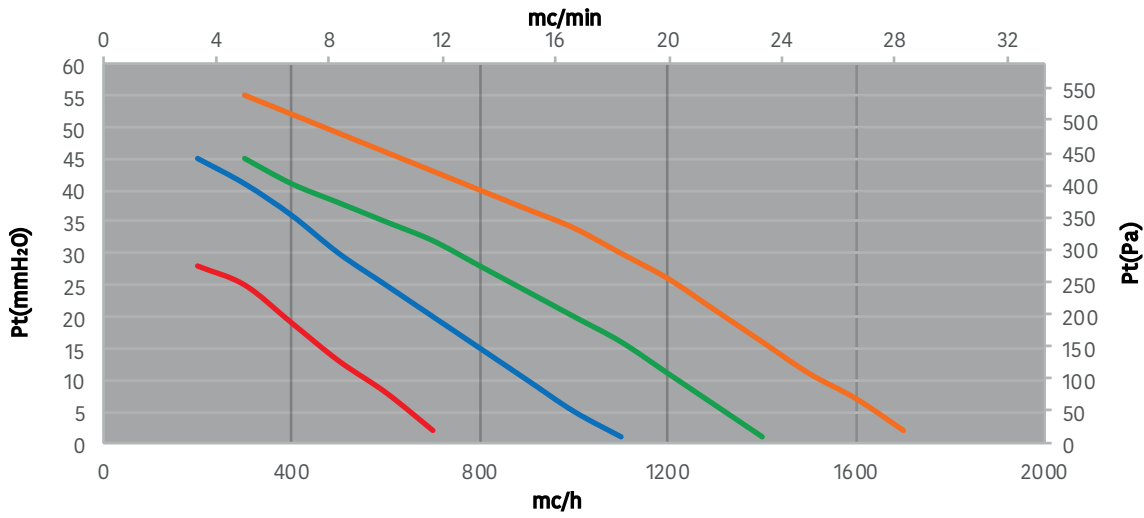

	VOLT	RPM
<b>FV-D 200</b>	230m	2900
<b>FV-D 315B</b>	230m	2900

	VOLT	RPM
<b>FV-D 250</b>	230m	2900

	VOLT	RPM
<b>FV-D 315A</b>	230m	2900

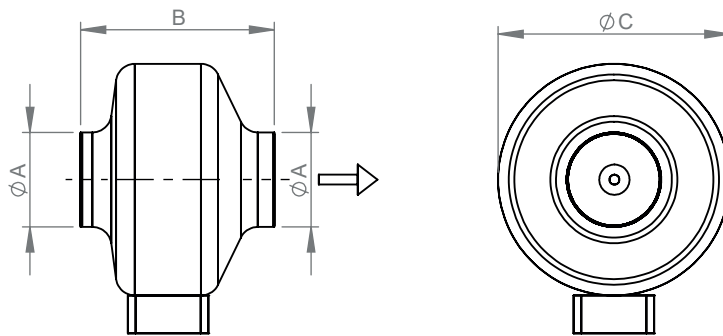

	ØA	B	ØC	Kg *
<b>FV-D 100</b>	100	205	245	3
<b>FV-D 125</b>	125	205	245	3
<b>FV-D 160A</b>	160	205	245	3
<b>FV-D 160B</b>	160	230	345	4
<b>FV-D 200</b>	200	220	345	5
<b>FV-D 250</b>	250	230	345	5
<b>FV-D 315A</b>	315	250	405	7
<b>FV-D 315B</b>	315	260	405	7

Dimensions in mm \* Indicative

**SB**

**WALL BRACKETS**

To be used to fix the fan on the wall

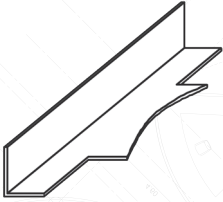

**RG**

**PROTECTION GRID**

Required to prevent accidental contact with rotation parts. mandatory for free air

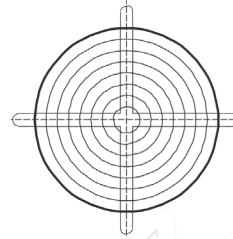

**FA**

**HOSE CLAMP**

To be used to connect the fan to the ducting.

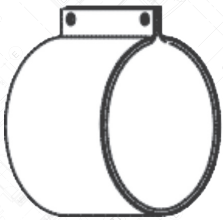

**SRE**

**SPEED**

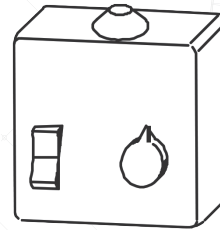

**SH**

**HUTTER**

Backdraught butterfly shutter



Sito Web



Catalogo Generale



**Feit Pompe S.r.l.**

Via Venezia, 34/g - 10088 - Volpiano (TO) - ITALIA  
Tel: +39 (0)11 9884327 - info@feit.srl - feit.srl

**FEIT**  
1946  
Evolving with you...